



COCHRANE-FOUNTAIN CITY SCHOOL DISTRICT

COMMUNITY FACILITY SURVEY

DEAR COMMUNITY MEMBERS:

The Cochrane-Fountain City School District is working on a plan to begin the next phase of projects in our Long-Range Facility Plan. There is a need to address large capital maintenance projects; update classrooms; expand and renovate the Career and Technical Education space (including the Family and Consumer Science room and the space formerly known as the shop); improve the libraries and support spaces; expand the weight room/fitness space, improve the bus shelter, and enhance the outdoor stadium space.

Ultimately, the District's goal is to finalize a plan that reflects the priorities of our taxpayers and meets the needs of both our students and the community. Therefore, we are asking you to take 10 minutes to complete this survey.

Sincerely,

Troy White

Cochrane-Fountain City School District Superintendent

TAKE THE SURVEY IN ONE OF THREE WAYS



Online

Scan the QR code with your smartphone camera, or visit bit.ly/CFC_survey to complete the survey online.



Mail

Call **608-687-4391** to have a survey mailed to you. Once complete, drop off or mail to the Cochrane-Fountain City School District: **S2770 State Road 35, Fountain City, WI 54629**.



www. Print

Download and print the survey at www.cfc.k12.wi.us. Once complete, drop off or mail to the Cochrane-Fountain City School District: **S2770 State Road 35, Fountain City, WI 54629**.

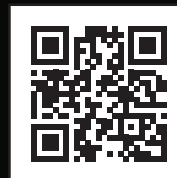

Scan with your
smartphone camera!

bit.ly/CFC_survey

All responses must be submitted online or returned by December 5, 2024

ABOUT YOU

1 What is your age?

- Under 18 18-25 26-34 35-54 55-64 65+

2 Do you live in the Cochrane-Fountain City School District?

- Yes No

3 In which city or township do you reside?

- Fountain City Cross Milton Lincoln
 Buffalo City Buffalo Waumandee Other
 Cochrane Belvidere Montana Do not live in the school district

4 Are you an employee of the Cochrane-Fountain City School District?

- Yes No

5 Do you have school-aged children?

- Yes No

6 If yes, do they attend the Cochrane-Fountain City School District?

- Yes No

7 Please select all that describe you:

- Own a home in the District Own commercial property in the District
 Rent in the District Own agricultural land in the District
 Own a business in the District None of the above

FACILITY PLANNING BACKGROUND

The District recently completed a facility assessment to better understand the condition and needs of the school. The study evaluated building systems, envelope, and finishes. In addition, the adequacy of educational spaces was analyzed.

The study identified the following needs:

- ✓ Public address/emergency notification system needs to be replaced
- ✓ Septic system requires replacement
- ✓ Remaining HVAC system updates need to be completed
- ✓ Aged and damaged flooring, ceiling, casework, and doors need to be replaced and asbestos abated
- ✓ Sections of the roof require replacement
- ✓ Parking lot needs to be repaved
- ✓ Restrooms do not meet ADA code compliance
- ✓ Updates and expansion are needed to the Career and Technical Education (CTE) classrooms and labs where woods, metals, family consumer science, small engine, auto, and other shop classes are taught
- ✓ Main entrance needs to be reconfigured to improve safety, including moving the elementary principal's office and a private conference room into the main office area
- ✓ Additional weight and fitness space is needed
- ✓ Libraries need to be redesigned to better meet current learning needs and support small and large group activities
- ✓ New concessions, bleachers, press box, and storage are needed at the athletic field
- ✓ A canopy is needed to shelter and maintain the bus fleet



A portion of the HVAC equipment has not been replaced and damage is evident.



Flooring is dated and damaged, causing safety concerns.

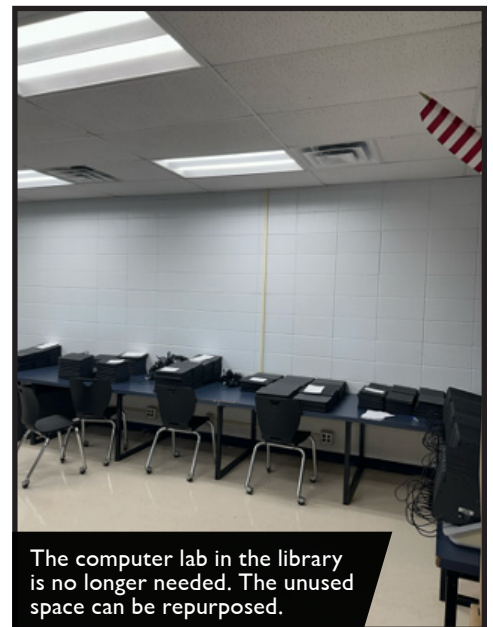

The computer lab in the library is no longer needed. The unused space can be repurposed.

FACILITY PLANNING BACKGROUND

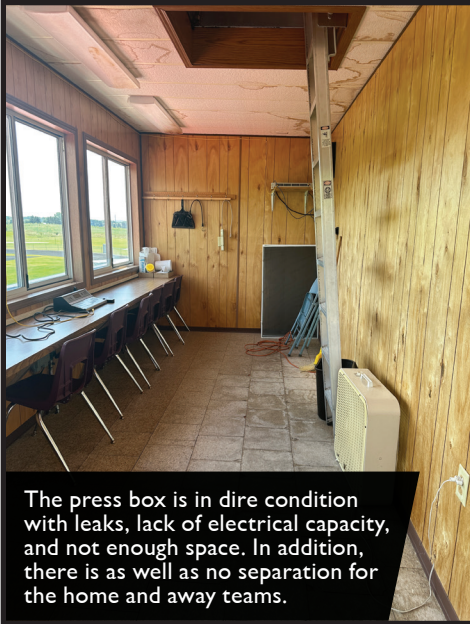

The press box is in dire condition with leaks, lack of electrical capacity, and not enough space. In addition, there is as well as no separation for the home and away teams.



Original doors that were installed in 1957 with wood casework are failing and many do not meet current ADA code requirements.

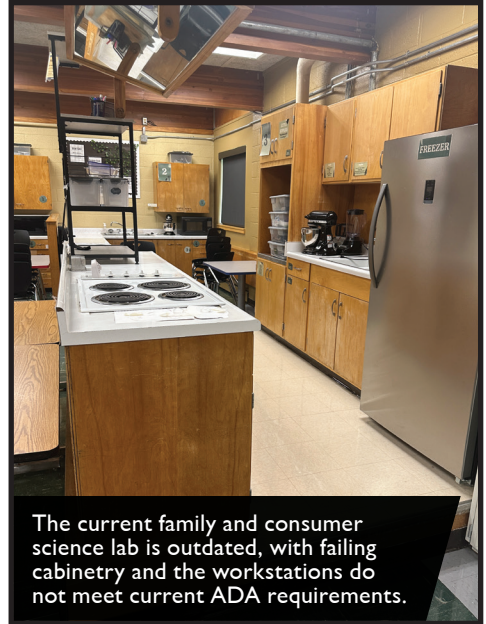

The current family and consumer science lab is outdated, with failing cabinetry and the workstations do not meet current ADA requirements.



The current shop is undersized and the multiple labs make it challenging to supervise all spaces.



Two vestibules into the school have rotted wood and are falling apart.

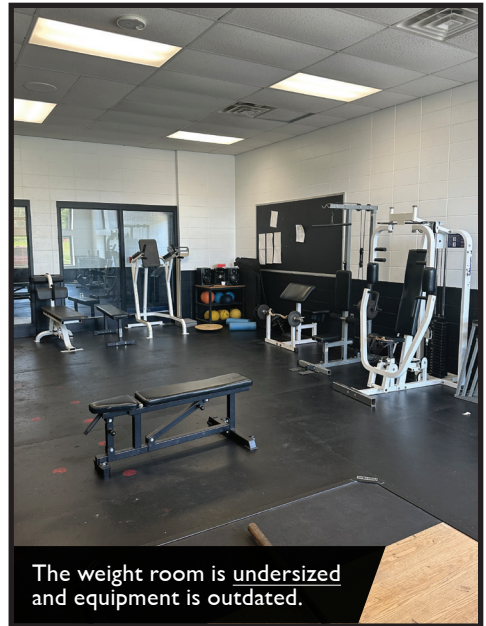

The weight room is undersized and equipment is outdated.

Comments/Suggestions:

FINANCIAL BACKGROUND

The District believes this is a good time to consider the next phase of projects in our schools. Due to careful financial planning our mill rate has continued to drop and is the lowest it has been in a decade.

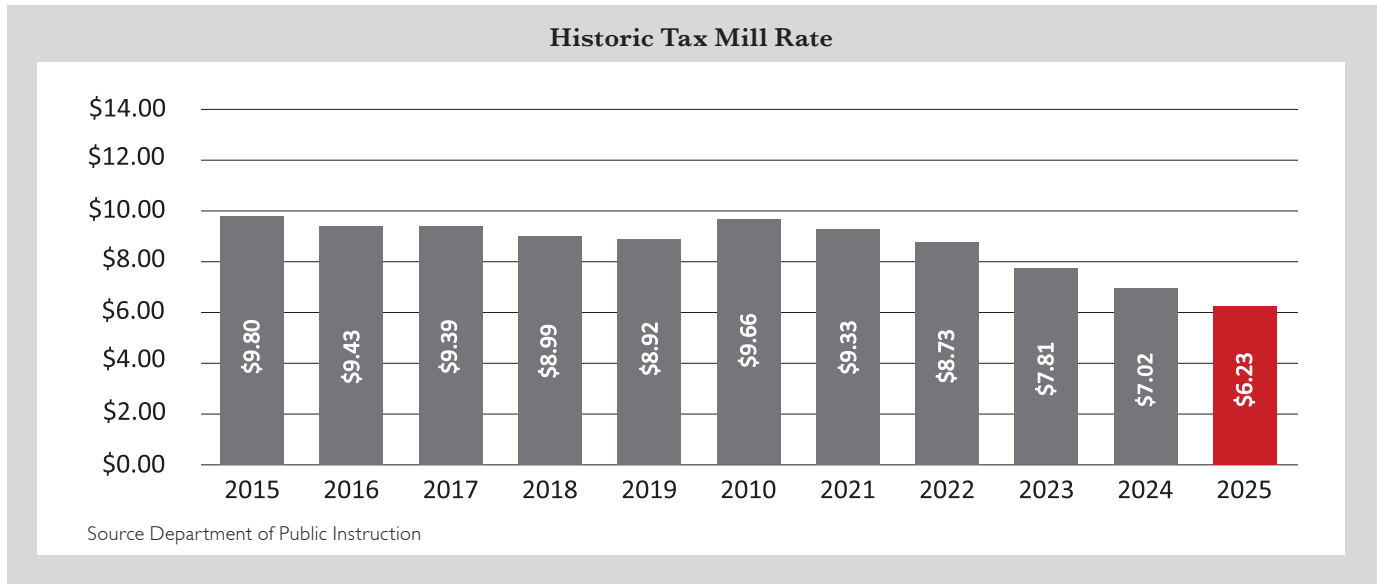

The District works hard to be a good steward of taxpayer dollars. The District's mill rate is the lowest of the school districts in our athletic conference.

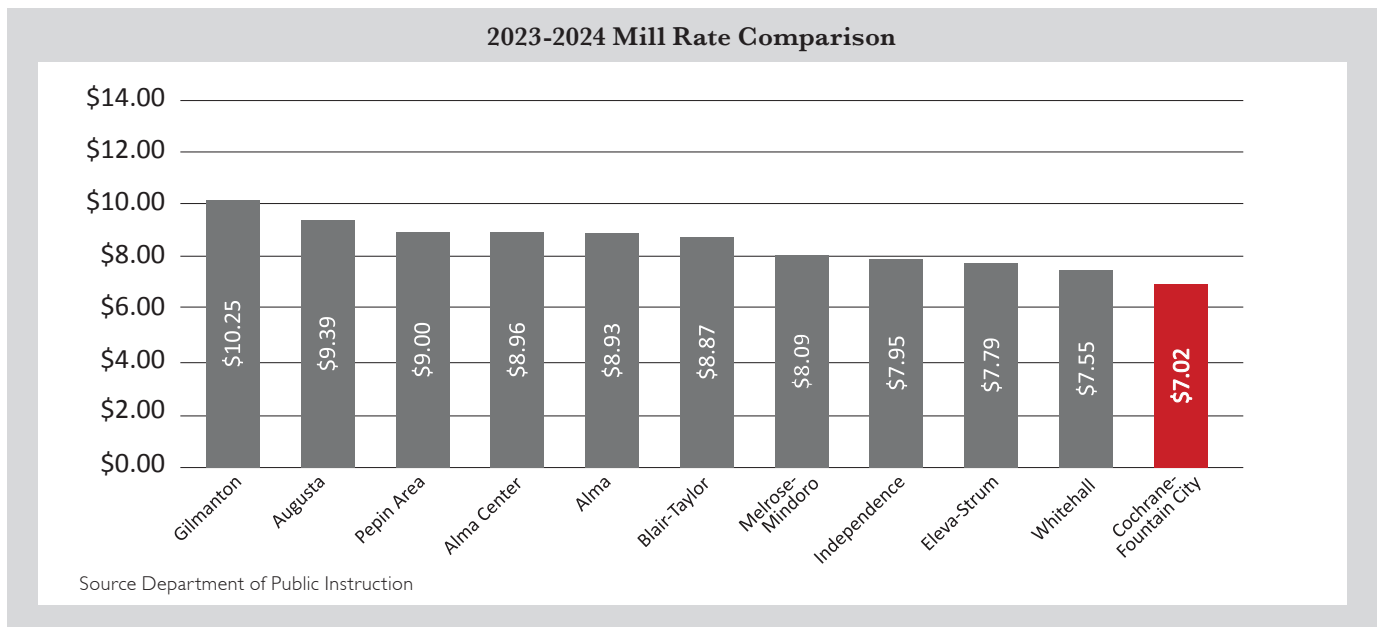

If the public chooses to address the District's facility needs, the primary way to obtain funding is through a voter-approved capital referendum.

Would you support the District exploring a capital referendum at this time?

Yes
 No
 Undecided/need more information

PROPOSED PROJECTS

If the community supports exploring a capital referendum, one or more of the following projects could be included:

Complete Capital Maintenance and Update Infrastructure

Although our school has been well maintained, many of the building's systems, infrastructure, and finishes have reached the end of their service life and are in need of replacement.

The following projects have been identified as the highest priority:

- Complete remaining roof section replacement
- Replace the septic system
- Update original 1967 restrooms that have failing plumbing and fixtures and do not meet current ADA code requirements
- Replace original damaged flooring and abate asbestos
- Rebuild school entrances that have rotted and are failing and install entrance security system
- Replace original 1957 interior doors that are failing and do not meet current ADA code requirements
- Update remaining HVAC equipment and controls throughout building
- Replace the non-working emergency notification/public address system in school
- Install and/or replace ceilings to improve acoustics in identified classrooms and abate asbestos
- Repave the parking lot

Estimated cost: \$10.76 million

Would you like to see the capital maintenance and infrastructure updates as described above included in a referendum?

Yes

No

Undecided/need more information

Comments/Suggestions:

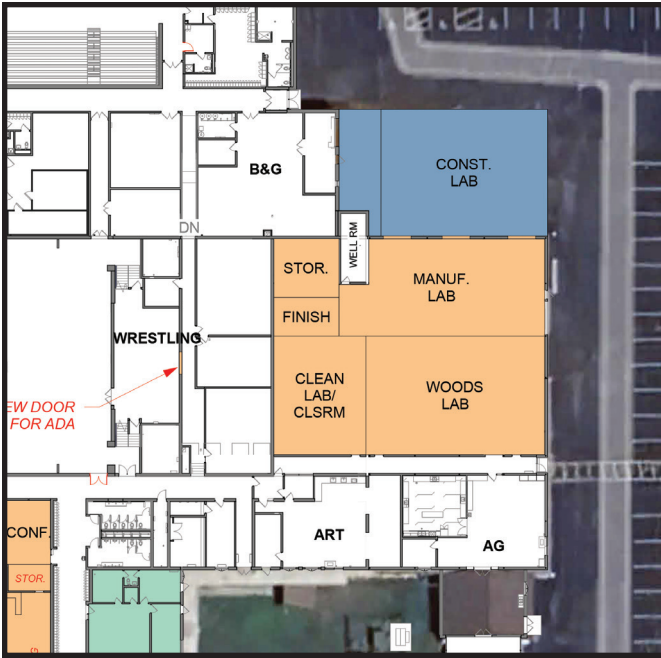

Update and Expand the Career and Technical Education (CTE) Classrooms and Labs

There is a growing demand for highly skilled employees in the trades. In recent years, nearly half of CFC graduates have reported entering the workforce in the trades. Based on this data, the District is committed to providing job-like experiences that prepare students for the workforce.

The current high school shop and family consumer science classroom are outdated and too small. As a result, students' course requests go unmet, class projects need to be moved and stored between classes, and staff have challenges supervising students as the equipment is located in multiple rooms.

This project would add appropriately sized classrooms and labs to teach woods/construction, metals, small engine repair, auto, family and consumer science, agri-science, and robotics courses. This will allow for more students to enroll and use of the latest technology and equipment.

Estimated cost: \$6.37 million

Would you like to see the update and expansion of Career and Technical Education (CTE) classrooms and labs as described above included in a referendum?

Yes

No

Undecided/need more information

Expand and Update the Weight/Fitness Room

The school's weight room is too small, making it challenging for a full team or physical education class to utilize the space safely at one time. This requires physical education teachers and coaches to regularly adjust their lessons and training schedules.

This project would include an updated and expanded weight/fitness room that would provide space for new and additional equipment, as well as allow for a dedicated entrance for use outside of the school day.

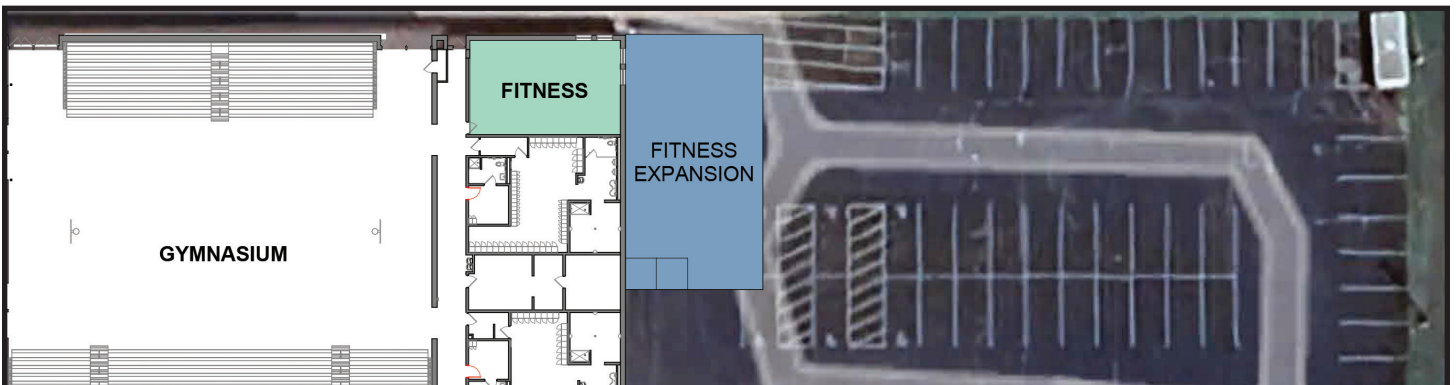

Estimated cost: \$1.66 million

Would you like to see the weight/fitness room update and expansion included in a referendum?

Yes

No

Undecided/need more information

Funding Support

The cost to address all of the needs covered in the survey is estimated at \$26 million. If voters support completing all of the projects identified in the survey, the tax mill rate will still be lower than what residents were paying in 2023.

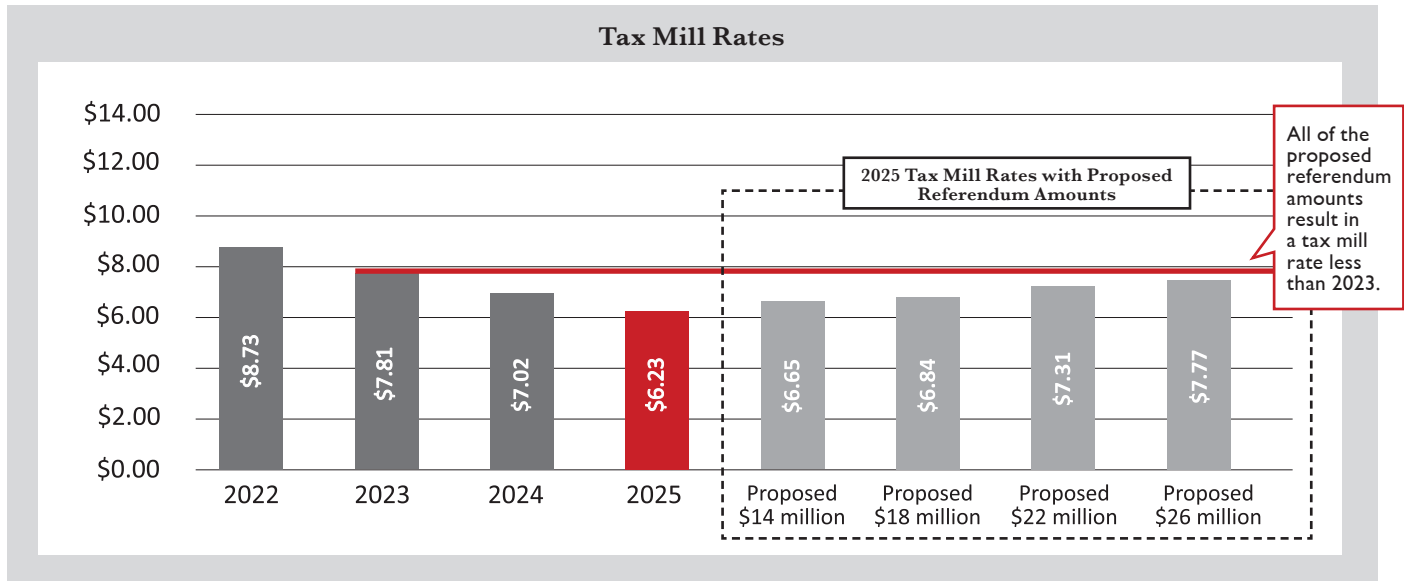

The following table shows the annual tax impact for various referendum amounts. The District would like to know your level of support to fund the projects, should they consider a referendum.

ESTIMATED PROPERTY TAX INCREASE				
Referendum amount	\$14 million	\$18 million	\$22 million	\$26 million
Estimated tax increase over the current level per \$100,000 of property value	\$42 (\$3.50/month)	\$61 (\$5.08/month)	\$108 (\$9/month)	\$154 (\$12.83/month)

<p>How much of a tax increase would you support through a referendum, assuming the projects included were acceptable to you?</p>	<ul style="list-style-type: none"> <input type="checkbox"/> I would support a \$26 million referendum <input type="checkbox"/> I would support a \$22 million referendum <input type="checkbox"/> I would support a \$18 million referendum <input type="checkbox"/> I would support a \$14 million referendum <input type="checkbox"/> I would support a <u>smaller</u> referendum <input type="checkbox"/> I would <u>not</u> support any referendum at this time <input type="checkbox"/> I'm not sure/need more information
--	--

All responses must be submitted online or returned by December 5, 2024

Mail or deliver to Cochrane-Fountain City School District: S2770 State Road 35, Fountain City, WI 54629.